

# GOLF launchpad™ TOUR™



## QUICKSTART GUIDE

### 1 COMPONENTS

Before play, please refer to the safety information in the Owner's Manual.



### 2 ASSEMBLY

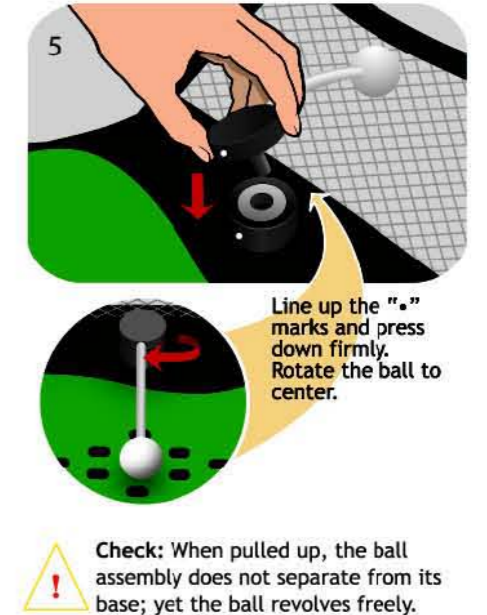
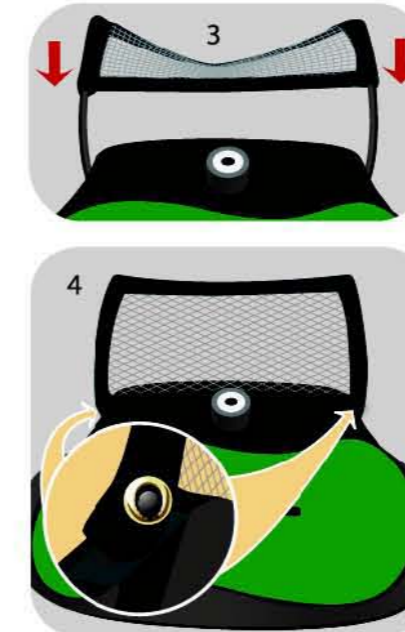
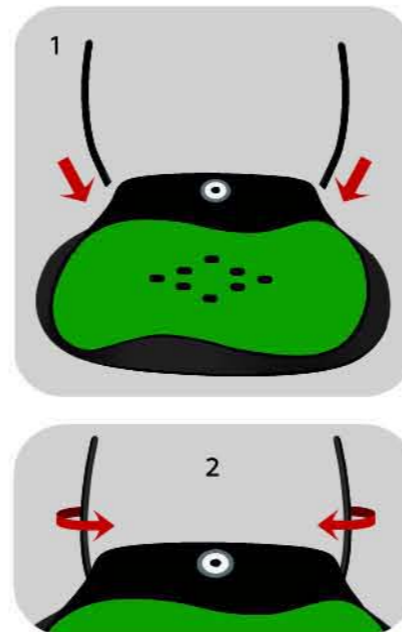

**Check:** When pulled up, the ball assembly does not separate from its base; yet the ball revolves freely.

### 3 GAME SETUP



#### Win/Mac Prepare to tee off

Install Tiger Woods PGA TOUR on your PC. Learn to play the game with the mouse. You will use the mouse for all game setup functions.

Launch Tiger Woods PGA TOUR and start a game. Select your club and choose your shot type and direction, then place the cursor near the player's hands until it looks like a curved arrow. Do not click.

#### PS3 Prepare to tee off

Press the button and ensure that Golf Launchpad is controller #1.

Use the Remote Caddy to start a new game prepare to tee off.

### 4 PLAYING A SHOT



### 5 PLAYING A ROUND

**Full swing shots:** Activate Launchpad in Drive Mode. If you lack swing room for your longer clubs, swing a shorter club having selected the best club for the shot in the game.

**Short Game:** When playing chip and pitch shots under 50 yards, activate Launchpad in Chip Mode.

**Putting:** Set shot direction in the game, activate Launchpad in Putt Mode and putt straight over the sensor grid.

**Realism:** The difficulty level in the game controls the level of realism. Tour Pro provides a lifelike experience, while Novice is good for beginners.



**electric spin**  
CORPORATION

www.electricspin.com  
171B Marycroft Av., Woodbridge,  
Ontario, Canada L4L 5Y3  
+1.416.410.1166/1.866.571.7746